

## Real-Time Network Visibility with Proactive Vulnerability Assessment and Prioritization

Today's organizations have virtually become borderless as devices are brought in and out of the environment due to increased workforce mobility. Organizations no longer have visibility into what systems and applications are running on the network at any given time. This makes it almost impossible to identify which vulnerabilities may exist within the network environment.

### Rapid Detection of Vulnerabilities and Complete Asset Discovery

Software and configuration vulnerabilities are growing exponentially. Almost 6,500 new vulnerabilities were disclosed and nearly 410,000 new examples of malware, including viruses, worms, back doors, key loggers, Trojans, spyware, and rootkits released.<sup>1</sup> Malware has increased by 500%, and major AV firms are falling behind on documenting known signatures.<sup>2</sup>

Even more alarming is that 90% of security vulnerabilities could be exploited remotely, i.e. over the network.<sup>3</sup> It's evident that organizations need a solution to address all of these concerns and improve their security posture; one that allows real-time visibility and proactive vulnerability management.

Lumension Scan is a complete stand-alone network-based scanning solution that performs a comprehensive assessment of all the devices connected to your network, both managed and unmanaged. Once all assets are identified Lumension Scan detects weaknesses on these devices before they can be exploited.

### Lumension Scan provides:

- » Complete identification and inventory of all devices on the network
- » Accurate scans of all devices for software and configuration-based vulnerabilities
- » Risk-based prioritization of identified threats
- » Continuously updated vulnerability database for orderly remediation
- » Actionable reports of scan results

### Key Features

- » Complete Asset Discovery
- » Comprehensive Vulnerability Coverage and Consolidated Library
- » Targeted Scanning Across Complex Distributed Networks
- » Customizable Vulnerability Set
- » Role-based Administration and Control
- » Supports Heterogeneous Networks
- » Automated, Non-Disruptive Scanning
- » Comprehensive Reporting
- » Risk-Based Prioritization
- » Common Criteria EAL2 Certified

### Key Benefits

- » Ensures Proactive Risk Management
- » Delivers Complete Visibility of all IT Assets
- » Provides Actionable Information for Orderly Remediation
- » Delivers One Solution for Complex Environments
- » Reduces IT Operating Costs

*"We were able to move to a more security centric view and scan on subnets and find rogue nodes on PCs that were deployed without the patch. We are able to quickly find them and react to that. So to roll out an agent becomes a centralized desktop implementation instead of going to the actual person. We can see what our vulnerabilities are and what some of the issues could be all from one screen and then quickly rectify the issue".*

**Anthony Sica - Executive Director of IT, Shiseido**

1. Aberdeen Group, Vulnerability Management Report, July 2008

2. AVtest.org

3. Aberdeen Group, Vulnerability Management Report, July 2008

## How Lumension Scan Works

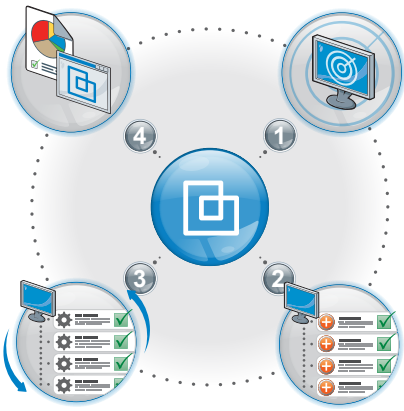

1. **Discover** - all network assets.
2. **Assess** - vulnerabilities and configurations with a comprehensive assessment scan.
3. **Prioritize** - threats and identify risk mitigation to aid in the remediation process.
4. **Report** - against compliance policies with executive and administrative views.

## Key Features

**Complete Asset Discovery:** Automates discovery of all network devices, major Operating Systems, and infrastructure.

**Comprehensive Vulnerability Coverage and Consolidated Library:** Vulnerability audits include security configurations, OS and application vulnerabilities, null passwords, patch-level related vulnerabilities, known hacking tools, malware, common worms, and P2P software checks.

**Adaptive and Targeted Scanning Across Complex Distributed Networks:** Provides the most accurate vulnerability assessment scan using flexible network-based scanning techniques with various access-levels including credentialed- and null-based.

**Role-based Administration and Control:** Enables distributed management of scan activity by user roles. Delegates remediation and reporting activities to improve productivity while maintaining security.

**Customizable Vulnerability Set:** Defines the scope of vulnerabilities to include in your scan. Offers a predefined list including CVE, Bugtraq, SANS, MS Advisory, NVD.

**Supports Heterogeneous Networks:** Effectively scans and assesses even complex and geographically distributed network environments across the WAN.

**Automated, Non-Disruptive Scanning:** Allows scheduling and automation of recurring scan tasks to run on a daily, weekly or monthly basis.

**Common Criteria EAL2 Certified:** The Common Criteria Evaluation and Certification Scheme (CCS) Certification Body has asserted that Lumension Scan complies with the all specified security requirements.

**Comprehensive Reporting:** Provides the ability to create and export numerous high-level or detailed reports of all scan data.

## System Requirements

- » **Server:** Windows XP, 2003
- » **Client:** BSD Unix, Cisco / IOS, CatOS, PIX, Cisco VPN, HP / HP-UX, HP / Tru64, IBM AIX, Juniper / JunOS, Fedora Linux / Mandriva, RHEL, SuSE Open/Enterprise Linux, Oracle Linux, Mac OS X, OpenBSD, Sun Solaris, Windows Server 2000, 2003, 2008, Windows XP, Vista

## [Complete Requirements](#)

## Online Resources

- » [FREE TRIAL](#)
- » [Vulnerability Management Blog](#)
- » [Vulnerability Scanner](#)
- » [Automating the Vulnerability Management Lifecycle](#)

## Contact Lumension

- » Global Headquarters  
15880 N. Greenway Hayden Suite 100  
Scottsdale, AZ 85260  
+1.480.970.1025  
[sales@lumension.com](mailto:sales@lumension.com)
- » United Kingdom  
+44.0.1908.357.897  
[sales.uk@lumension.com](mailto:sales.uk@lumension.com)
- » Europe  
+352.265.364.11  
[sales-emea@lumension.com](mailto:sales-emea@lumension.com)
- » Asia & Pacific  
+65.6725.6415  
[sales-apac@lumension.com](mailto:sales-apac@lumension.com)

[www.lumension.com](http://www.lumension.com)

Vulnerability Management | Endpoint Protection | Data Protection | Reporting and Compliance

